



© Copyright by Holland Pump Company 2003

Section: 30-45
26 June 06

12" Hydraulically Driven Submersible System
Model H12TP - D608T
Size 12" Trash Pump

Holland® Pump Company
 Corporate Office: 2610 Sidney Lanier Drive
 Brunswick, Georgia 31525
 Phone 912-466-0304
 1-888-997-PUMP
 www.hollandpump.com

PUMP SPECIFICATIONS

Size: 12" Trash Pump
Volute: Fabricated Steel (optional stainless steel and special abrasion resistant steel volutes are available)
Impeller: Semi-open, 3 Vane. Handles 4.5" diameter compressible spherical solids. (optional stainless steel or special abrasion resistant steel impellers are available)
Impeller Shaft: Stainless steel
Seal: Rotary Mechanical, oil-lubricated, carbon & ceramic

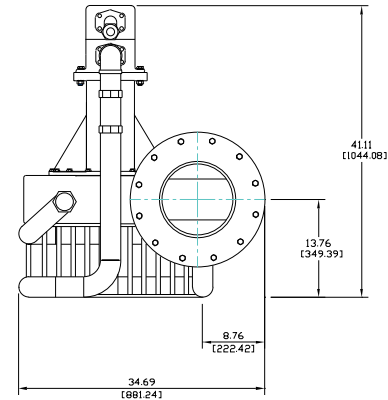
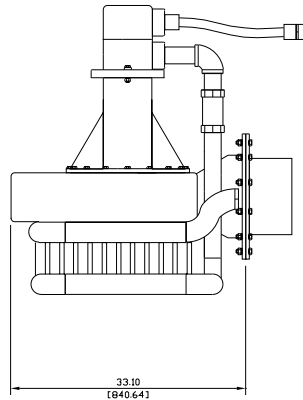

Holland 12" Trash Pump

Hydraulic System

Hydraulic Reservoir level: 50 gallon capacity with twin 10 micron spin on oil filter
Biodegradable Oil: Furnished standard (optional petroleum based hydraulic oil available)
Hydraulic Pump: Denison vane type positive displacement pump with pilot operated Denison relief valve
Hydraulic Motor: Vickers vane type positive displacement motor
Heat Exchanger: Double row, SCH 40 pipe with integral intake basket (optional engine mounted oil cooler available)
Hydraulic Hose: 50' set of SAE 100R2, two wire braid high-pressure hose
Pump Head Fail Safe Pressure Relief System: Available as option to protect system against improper connection or interruption of hydraulic oil flow from pump head to power unit

ENGINE SPECIFICATIONS

Model: Deere 6068T
Type: 6 Cylinder, 4 Stroke, Turbocharged, Liquid Cooled Diesel Engine
Displacement: 6.8 L (414 cu.in.)
Governor: Mechanical
Lubrications: Forced Circulation
Air Cleaner: Dry Type with Replaceable Element
Lube Oil Capacity: 5 U.S. Gallons
Coolant Capacity: 5 U.S. Gallons
Fuel Tank: Integral 240 U.S. Gallon Capacity (#2 Diesel Fuel)
Full Load Operating Time: 60 Hours Minimum
Starter: 12 Volt
Standard Features: Skid, SAE 3 Flywheel Housing, SAE 11 1/2" Flywheel, Electric Start, Safety Shut Down, System Covering: Engine Temperature and Low Oil Pressure
Optional Features: Auto-Oiler with Engine Oil Shutdown, Site or DOT Highway Trailer, Automatic Remote Start and Stop, HANS (Holland Automatic Notification System), Full Instrument Package Covering: Air Filter, Fuel Filter, RPM, Radiator Coolant Level, Fuel Level
Coupling: SAE 3 Bell housing adaptor, Stromag coupling

H12TP @ 2000 PSI	Capacity of Pump in U.S. Gallons per Minute (gpm) (Continuous Performance)
20' Head	4200
10' Head	4500

Cummins Published Performance: Maximum Continuous Power: 155 BHP (116kW) @ 2200 RPM

Specifications subject to change without notice



© Copyright by Holland Pump Company 2003

12" Hydraulically Driven Submersible System
Model H12TP - D6068T
Size 12" Trash Pump

Holland® Pump Company
Corporate Office: 2610 Sidney Lanier Drive
Brunswick, Georgia 31525
Phone 912-466-0304
1-888-997-PUMP
www.hollandpump.com

Approximate Dimensions
Powered by John Deere 6068T
Tandem Axle Trailer Shown

	Skid Base	DOT Trailer	Pump
Net Weight (lbs)	4060	4660	690
Shipping Weight (lbs)	4160	4760	740
Export Crate Size (cu. ft)	350	N/A	28

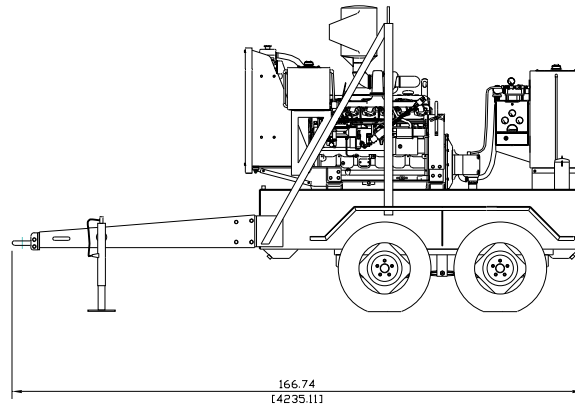
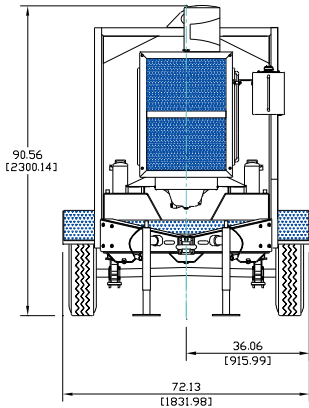

Performance Curve Model: H12TP - D6068T
Size: 12" Trash Pump

TOTAL HEAD
PSI FT

